

# MARINE PRODUCT DATA SHEET

**OEM:** 1700-010-030 (800 GPH)

**AFTERMARKET:** 1700-011-030 (800 GPH)

## APPLICATION

12V DC Bait/Livewell tanks water circulation

## PUMP

Type: Centrifugal Pump, Magnetic Drive  
Outlet Port: 3/4" Barb  
Inlet Port: 3/4" NPT-M  
Wash-Down Port: 1/2" NPT-F  
Liquid: 130 °F [54 °C] Max  
Prime: Flooded Inlet  
Inlet PSI: 30 PSI [2.1 Bar] Max  
Run Dry: Yes

## ELECTRICAL

Motor: 12VDC Permanent Magnet,  
Continuous Duty  
Protection: Need External Fuse (Not supplied)  
Leads: 6 ft [1.8M] Tinned, Twisted Jacketed Cable  
Fuse: 5 Amp Recommended  
Control: No Control

## MATERIALS

Housing: High Strength Nylon  
Impeller: Acetal  
Hardware: Stainless Steel

## APPROVALS

Ignition Protected 8846, CE

## WARRANTY

3 Year Limited Warranty. Contact SHURflo for details

## SHIPPING

Net Weight (Boxed): 2.5 Lb [1.1 Kg] each  
Approx. Lbs./Ctn. 14 Lb [6.3 Kg]  
Pumps in Carton: 6  
Carton Size: 16"L x 11"W x 11" H  
[41cm x 28 cm x 28 cm]

## RELATED DOCUMENTS

Catalog: MS-030-140  
Installation Manual: 911-466  
Applications Spec Guide: MS-020-005



The Bait Sentry Livewell Pumps are designed for easy installation and trouble-free operation. Magnetic Drive technology eliminates unnecessary failures. Motors keep running after ingesting debris or even when running dry. Patented anti-airlock feature allows the pump to clear trapped air in rough water or when boat is anchored. Includes dual port for easy washdown pump connection.

Exploded View—No Parts Kits Available

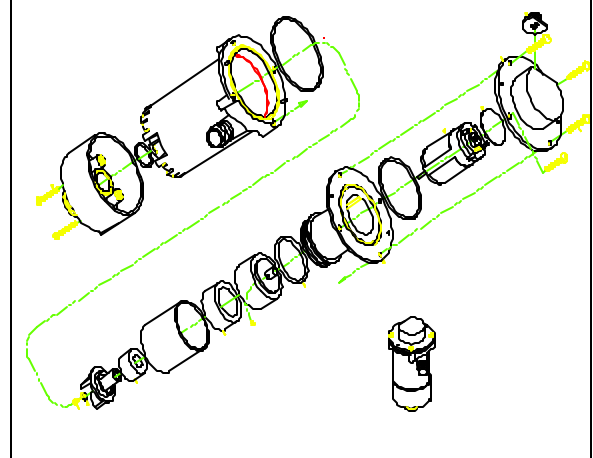

TYPICAL PERFORMANCE

PRESSURE		FLOW		CURRENT
METERS	FT OF HEAD	GPH	LPH	AMPS
0.0	0	800	3028	3.5
1.5	5	390	1476	2.6
2.7	9	0	0	2.2

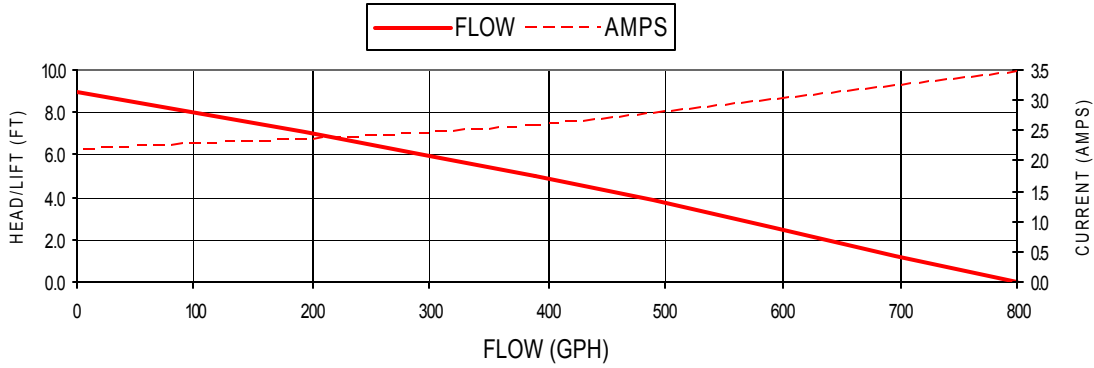

DIMENSIONS [mm]

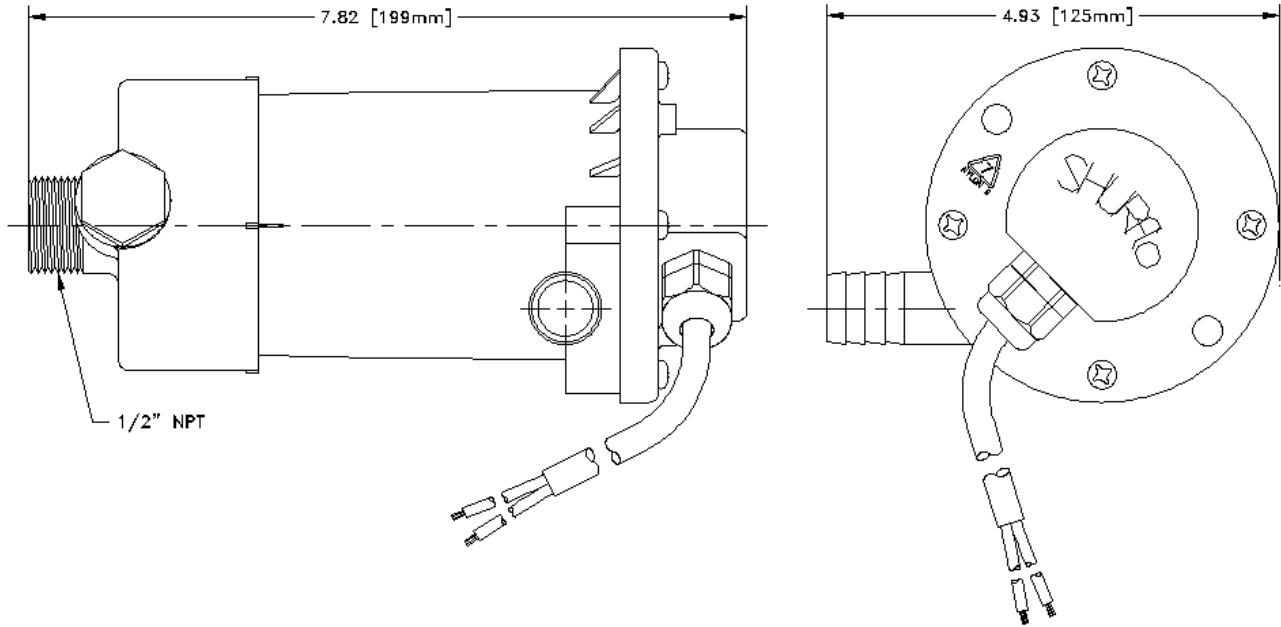

Visit our Web Site at <http://www.shurflo.com>  
 Shurflo reserves the right to update specifications,  
 change prices, or make substitutions without notice.



**SHURflo**  
 5900 Katella Avenue  
 Cypress, CA 90630  
 Phone (562) 795-5200  
 Toll Free (800) 854-3218  
 Fax (562) 795-7564

**SHURflo East**  
 52748 Park Six Court  
 Elkhart, IN 46514-5427  
 Phone (562) 795-5200  
 Toll Free (800) 854-3218  
 Fax (574) 264-2169

**SHURflo Europe, Middle East, Africa**  
**Pentair Water Belgium bvba**  
 Industriepark Wolfstee, Toekomstlaan 30  
 B-2200 Herentals, Belgium  
 Phone +32-14-283500  
 Fax +32-14-283505



**Pentair Water**

**FLOW TECHNOLOGIES GROUP**  
 5900 Katella Ave, Cypress, CA 90630  
 Phone (800) 854-3218 • (562) 795-5200 • Fax (562) 795-7564  
[www.shurflo.com](http://www.shurflo.com)